

**KUVANVEISTOSALI**  
SCULPTURE GALLERY

180 m<sup>2</sup>

- Stone walls
- Stone floor
- Bearing capacity of the floor 400kg/m<sup>2</sup>

- Few hanging points on the ceiling

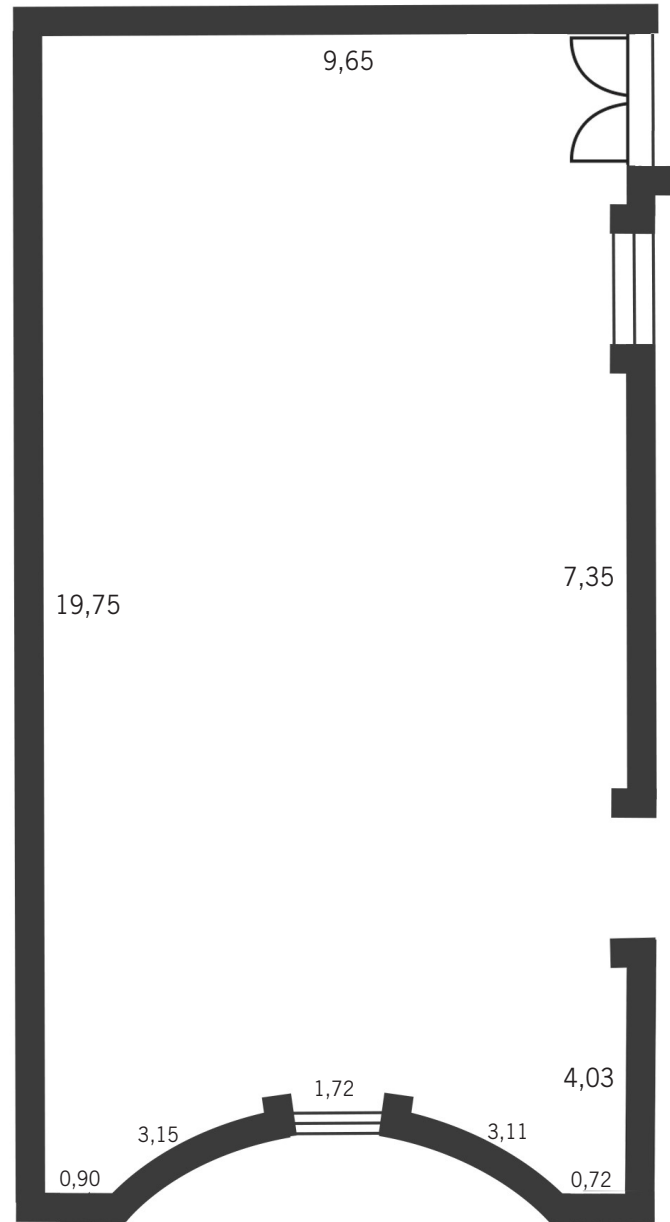
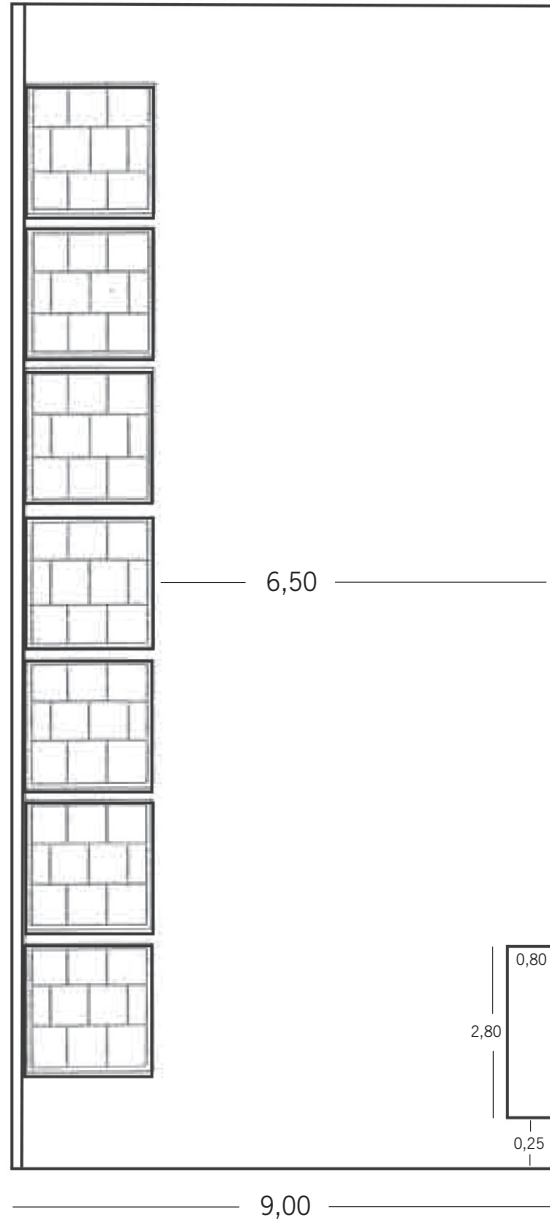

**Emergency exit**

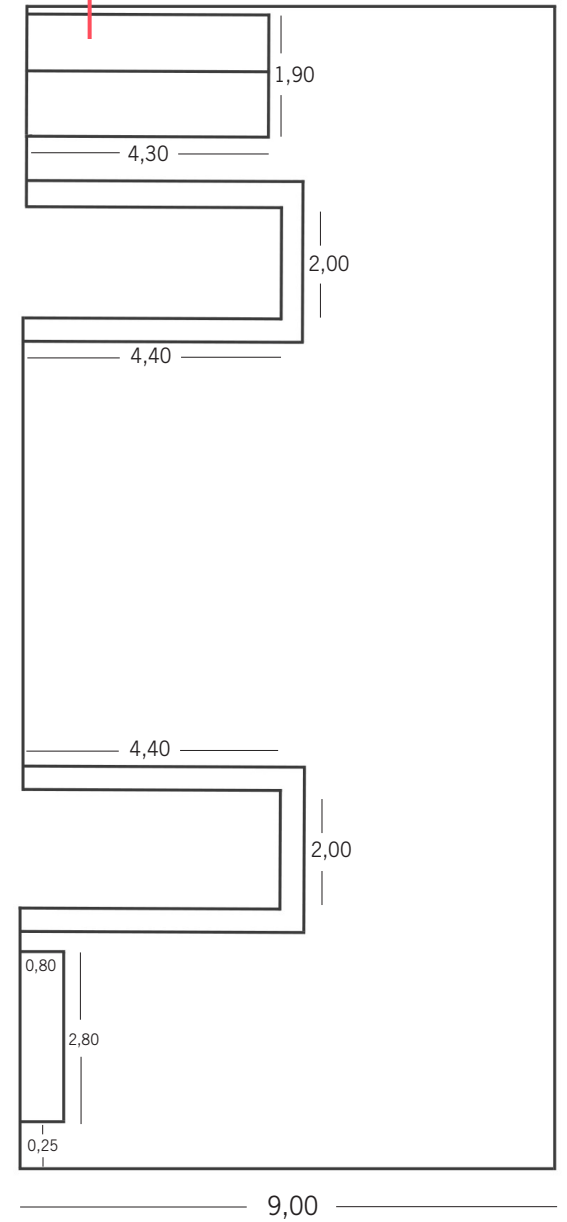

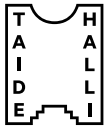

# KUVANVEISTOSALI SCULPTURE GALLERY

180 m<sup>2</sup>

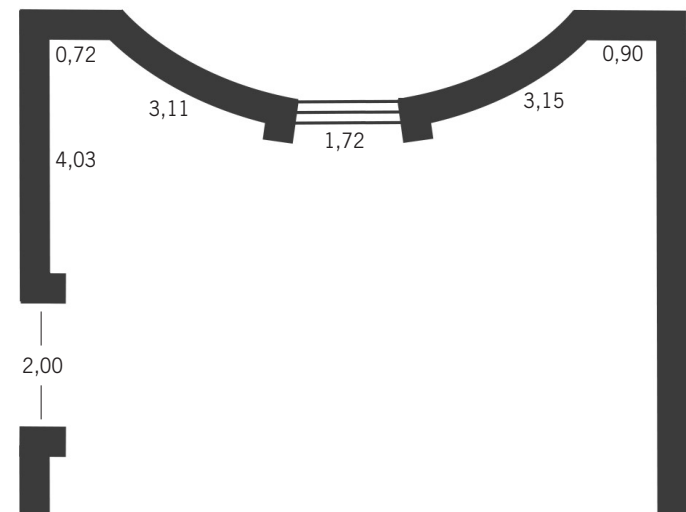
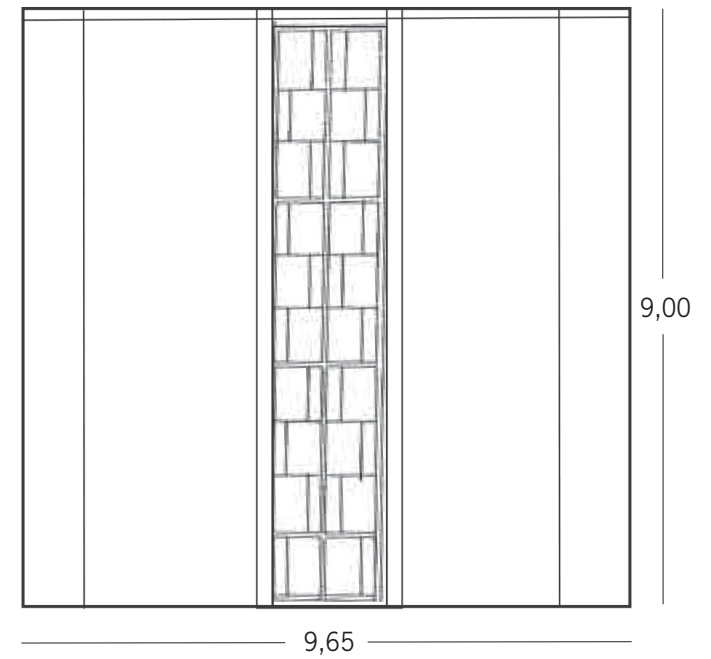
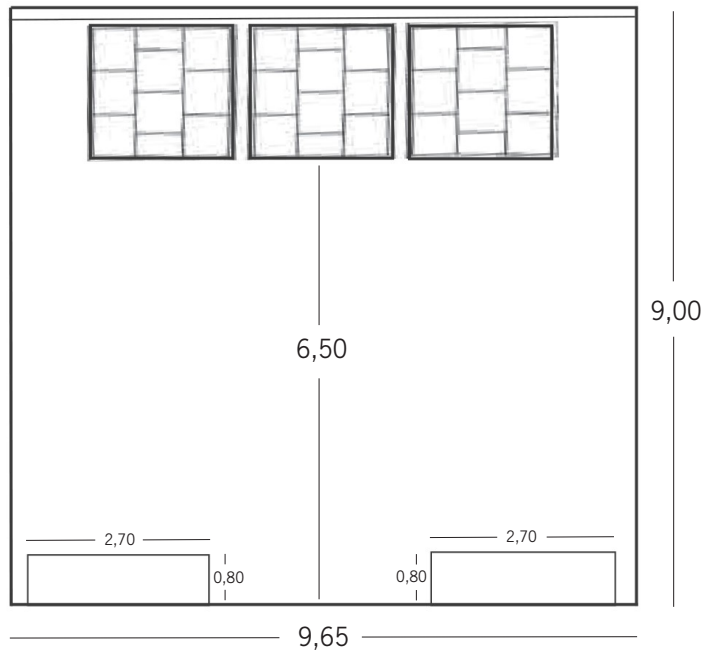

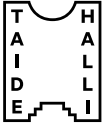

- Stone walls
- Stone floor
- Bearing capacity of the floor 400kg/m<sup>2</sup>

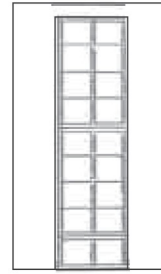

- The window is covered with a light false wall
- Wall is suitable for hanging

- Few hanging points on the ceiling

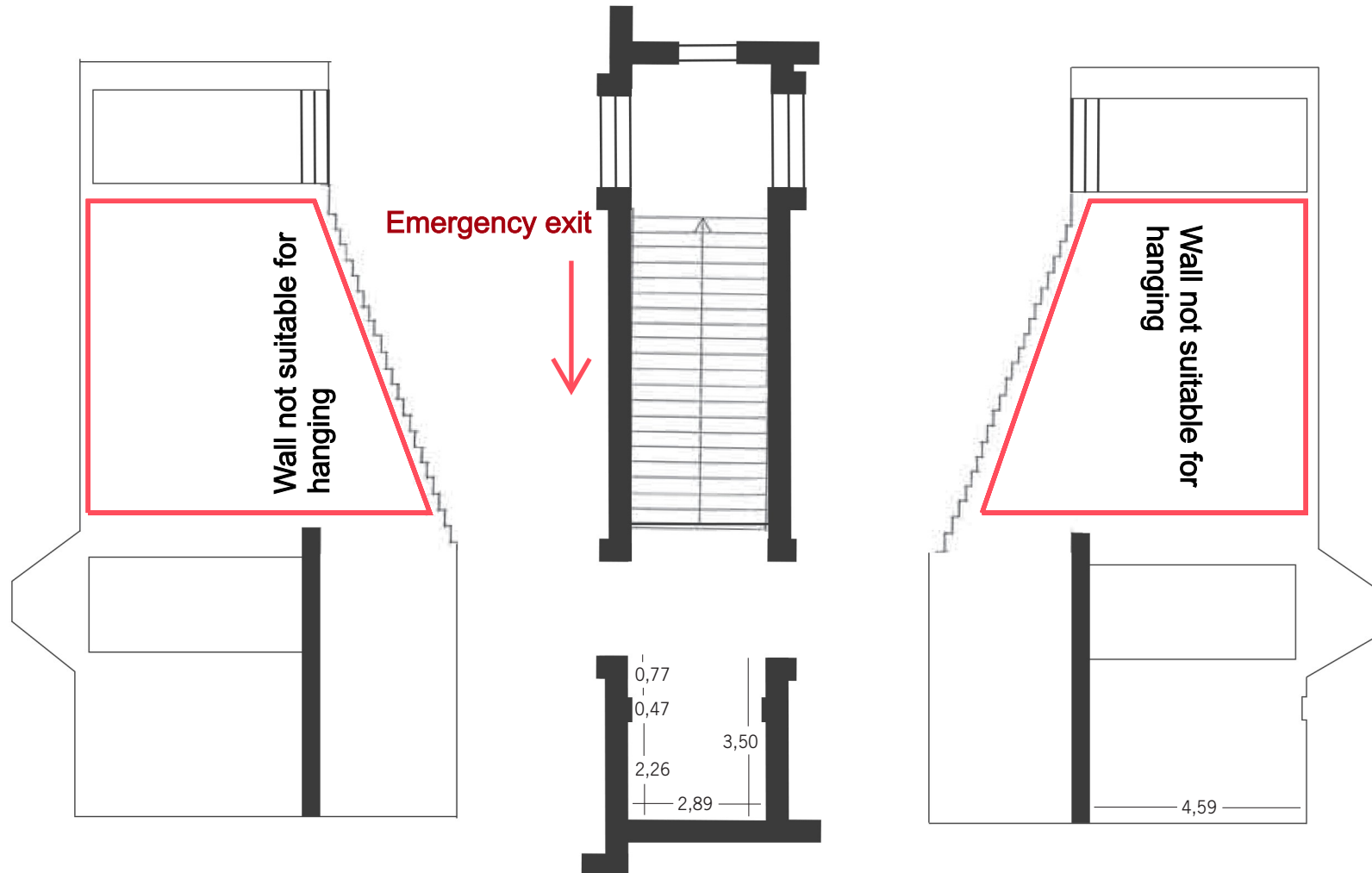

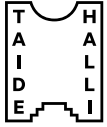

**KESKISALI**  
MIDDLE GALLERY

155 m<sup>2</sup>

- Drywall and plywood walls
- Wooden floor
- Bearing capacity of the floor 250kg/m<sup>2</sup>

- Few hanging points on the ceiling
- Blue marks the points

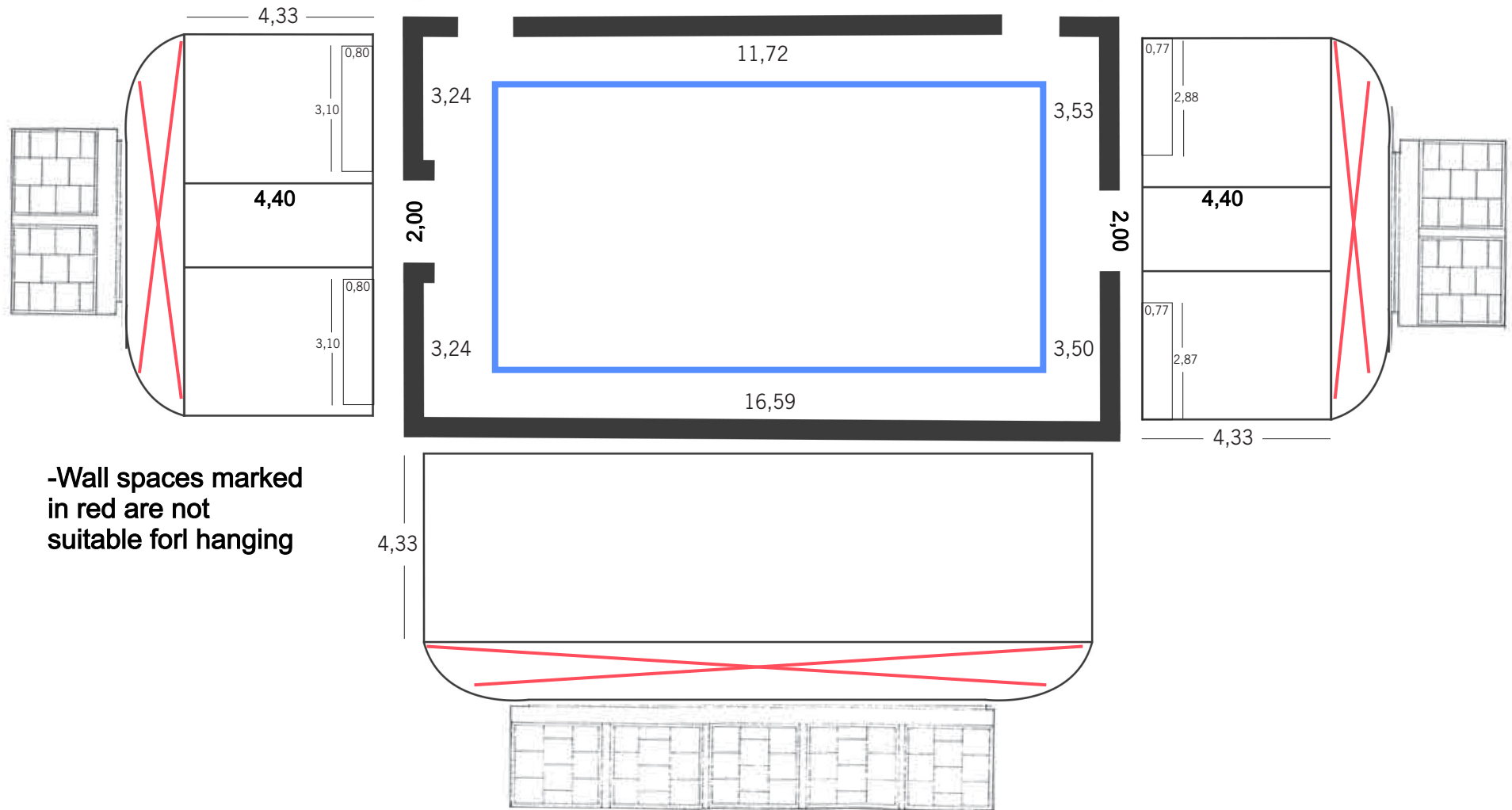

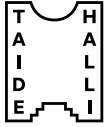

**TAKASALI**  
REAR GALLERY

150 m<sup>2</sup>

- Drywall and plywood walls
- Wooden floor
- Bearing capacity of the floor 250kg/m<sup>2</sup>

- Few hanging points on the ceiling
- Blue marks the points

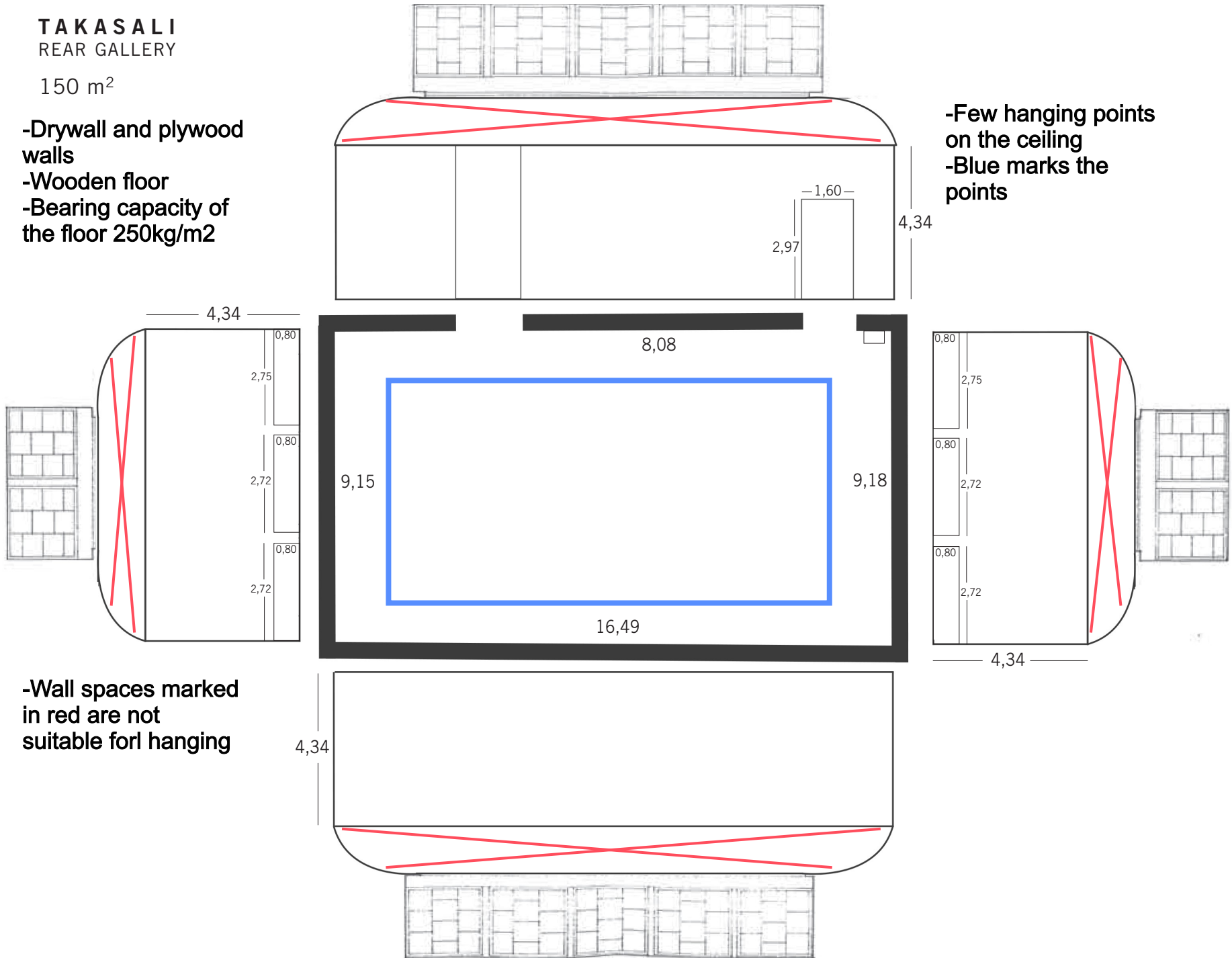

- Wall spaces marked in red are not suitable for hanging

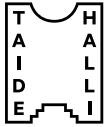

**PIENI SALI**  
SMALL GALLERY

150 m<sup>2</sup>

- Drywall and plywood walls
- Wooden floor
- Bearing capacity of the floor 250kg/m<sup>2</sup>

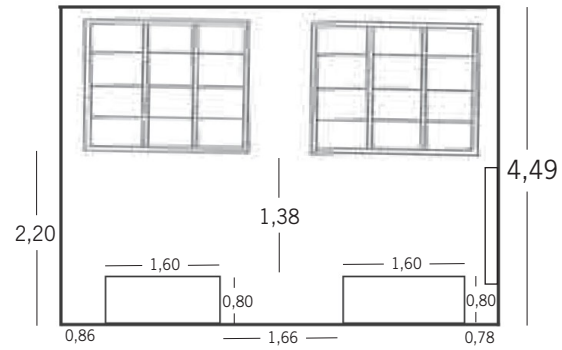

- The window is covered with a light false wall
- Wall is suitable for hanging

- Few hanging points on the ceiling

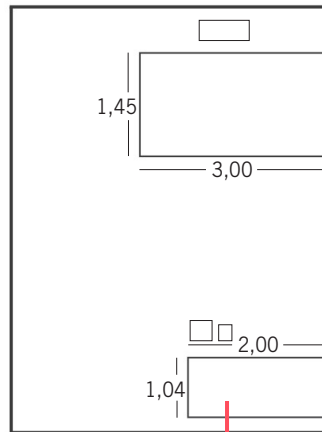

**Emergency exit**

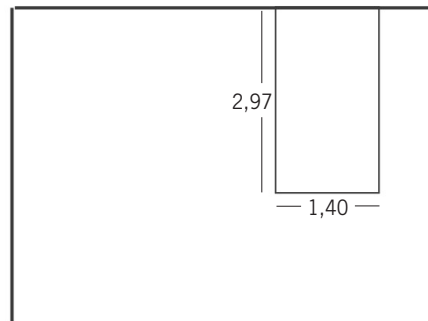
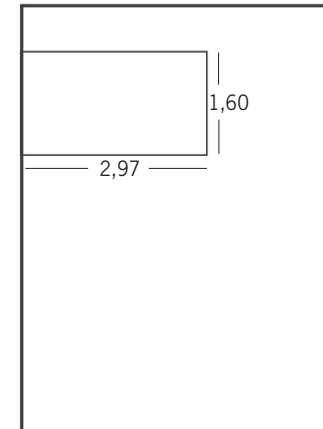
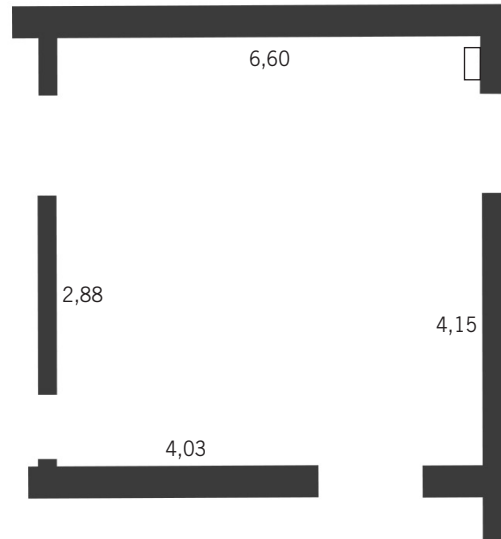



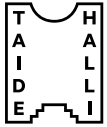

# KÄYTÄVÄ HALLWAY

- Drywall and plywood walls
- Wooden floor
- Bearing capacity of the floor 250kg/m<sup>2</sup>

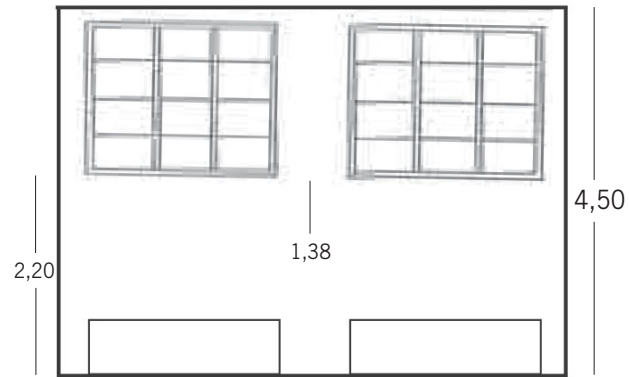

- Few hanging points on the ceiling

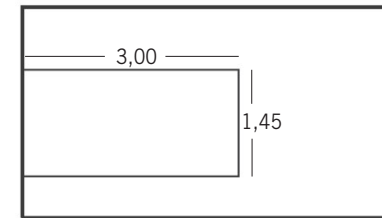
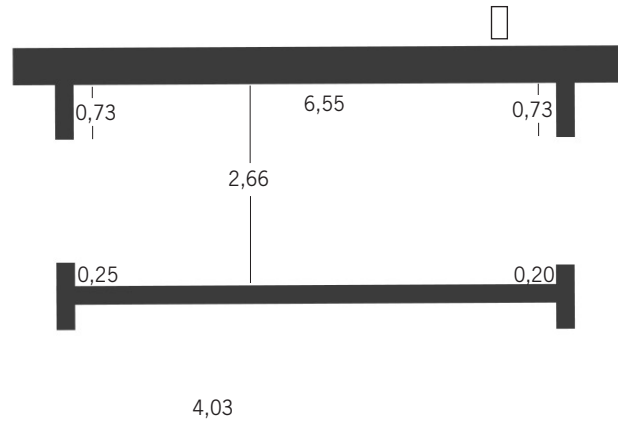
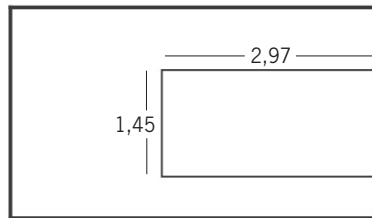

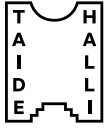

# HISSIHUONE

ELEVATOR ROOM

- Drywall and plywood walls
- Wooden floor
- Bearing capacity of the floor 250kg/m<sup>2</sup>

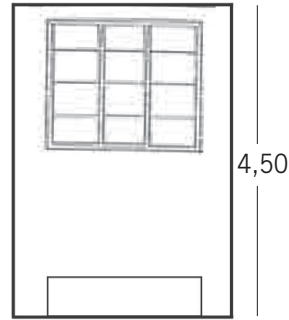

- The window is covered with a light false wall
- Wall is suitable for hanging

- Blue line marks the only wall available for hanging

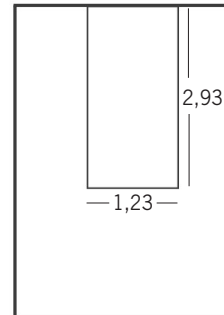
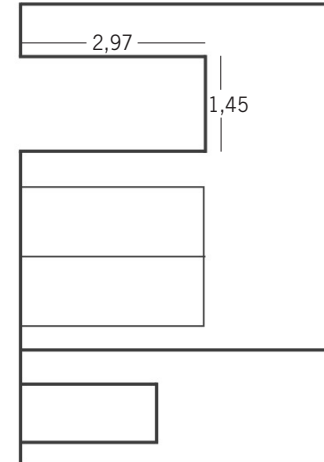
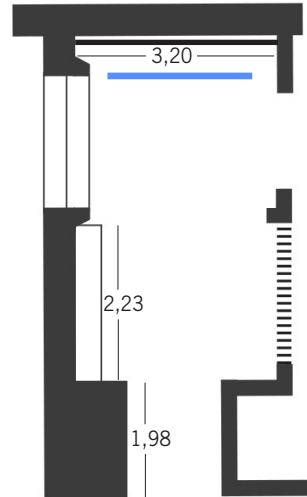
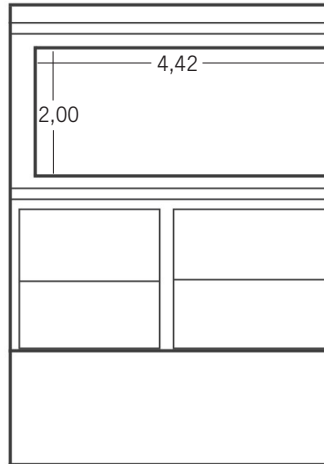



- Terrace is not part of the exhibition spaces.
- All the windows can be covered with blackout curtains and blinds, except there are no blinds for the tall window in the sculpture gallery.
- Exhibition spaces can be light up with spot lights and wall washers that we have a limited amount for use.
- Sculpture gallery has general lights on the ceiling and points for spot lights.
- Middlegallery and rear gallery can also light up with general lights.

**In any of the gallery spaces the following is not allowed:**

- Hang anything too heavy from the ceiling.
- Make any new holes to the ceiling
- Make any holes or heavy fixings to the floor.
- Block or hide emergency exits.
- All routes are emergency exits and cannot be completely closed.